

Spool Installation Instructions

Covers Part #5381X

Removal and Installation of Front Differential

1. Remove the two servo links from the steering servo saver input arm (Photo A).
2. Remove screws holding the shocks to the rockers (Photo B).
3. Remove body mount screw and take off body/bumper mount by pulling forward.
4. Loosen the shock mounting screws (Photo B) so they are free of the bulkhead. Do not remove the screws, they will keep the shock from falling out, but the screws must be out far enough to disengage the bulkhead.
5. Remove all 4 chassis screws (Photo B - Set 1 and Set 2).
6. Remove the screws that hold the rockers to the posts (Photo B) and lift off the rockers. **Note:** If the rocker posts back out with the screws, simply thread them back in after removing the screws.
7. Remove the screw pin that secures the brake mount yoke to the transmission output shaft (Photo E).
8. Slightly lower the front of the bulkhead from the chassis and slide it out of the chassis. The steering system, differential, front drive shaft assembly and suspension assembly will slide out with the bulkhead.
9. Remove the screw pins from the left and right diff output yokes.
10. Before removing the yokes, rotate the drive shafts so the screw pin holes in the yokes are both facing forward (toward the bumper)(Photo C). This will allow the flat parts of the output shaft to line up with the grooves in the bulkhead (Photo D).
11. Remove the diff by placing a finger under each output shaft and pushing it up and out of the bulkhead.
12. Install in reverse order of disassembly.

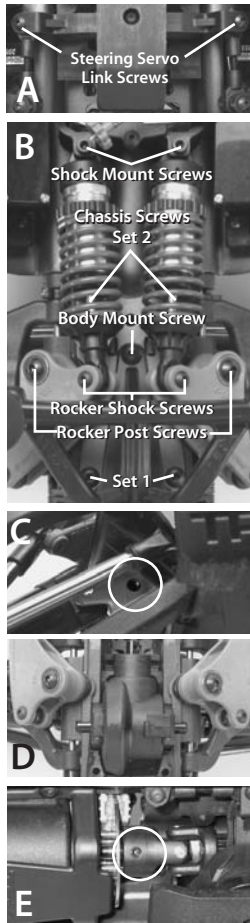

Reassembly Notes:

- While inserting the bulkhead assembly onto the chassis, guide the brake yoke onto the transmission output shaft (this can be easily achieved if the vehicle is held vertical during the insertion process).
- **On the diff housing you will see "Revo Up" and an arrow. When installing the diff back into the bulkhead, the words "Revo Up" should be visible.**
- Connect the shocks to the rockers before installing the front body mount. The body mount should be installed last.

Spool Installation Sequence (Diffs Removed)

1. Remove the four 3x10-caphead machine screws to access the differential carrier and ring gear assembly. Remove the carrier and ring gear assembly from the housing.
2. Remove the two 10x15 & 8x16 differential output bearings from the differential housing. Remove the four 2.5x8-caphead machine screws from the ring gear, and separate the ring gear from the carrier. Remove the output shaft and X-ring from the ring gear.
3. Clean the ring gear with denatured alcohol, and position the ring gear to the spool with the four holes aligned (see illustration for correct orientation). Secure the ring gear to the spool with the same four 2.5x8-caphead machine screws. Reinstall the two differential output bearings onto the assembly.
4. Lube the spool/ring gear with a light coating of automotive wheel bearing grease, and insert the assembly into the diff housing. Replace the cover. Installation of the differential assembly is the reverse of removal.

Removal and Installation of Rear Differential

1. Remove screws holding the shocks to the rockers (Photo G).
2. Remove the body mount screw and chassis screws (Photo G), remove the body mount by pulling rearward. **Be careful not to damage the EZ-Start wires.**
3. Remove the two engine mount screws from the bottom of the truck (Photo F).
4. Loosen the shock mounting screws so they are free from the bulkhead (Photo G). Do not remove the screws, they will keep the shock from falling out. The screws must be out far enough to disengage the bulkhead.
5. Remove the screws that hold the rockers to the posts (Photo G) and lift off the rockers. **Note:** If the rocker posts back out with the screws, simply thread them back in after removing the screws.
6. Remove the screw pin that secures the center drive shaft yoke to the diff.
7. From the top of the chassis, place a flathead screwdriver between the chassis and the aluminum bulkhead brace. With a light prying motion toward the front of the chassis, gently pry the rear bulkhead off the chassis.
8. Remove the screw pins from the left and right diff output yokes.
9. Before removing the yokes, rotate the drive shafts so the screw pin holes in the yokes are both facing toward the bumper (Photo C). This will allow the flat parts of the output shaft to line up with the grooves in the bulkhead (Photo H).
10. Remove the differential by placing a finger under each output shaft and pushing it up and out of the bulkhead.
11. Install in reverse order of disassembly.

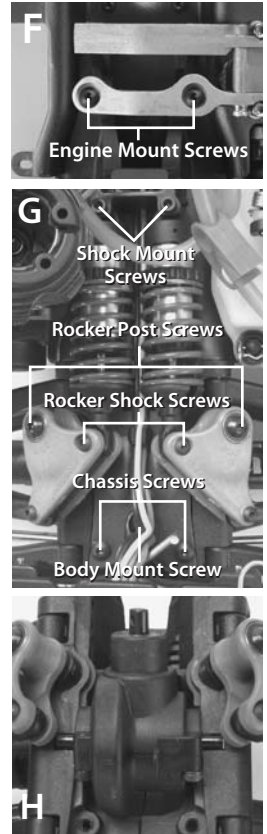

Reassembly Note:

- Be sure the EZ-Start wires are in the keepers before you connect the rear shocks to the rockers and install the body mount and chassis screws.
- **On the diff housing you will see "Revo Up" and an arrow. When installing the diff back into the bulkhead, the words "Revo Up" should be visible.**

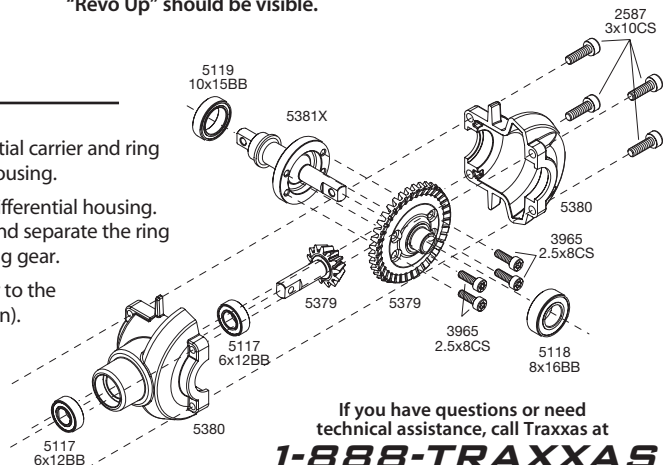

If you have questions or need technical assistance, call Traxxas at
1-888-TRAXXAS
 (1-888-872-9927) (U.S. residents only)